

Link arm door closers

CT500

The CT500 is a door closer that offers good performance in a compact size.

It can drive doors from size 2 to 3. This means that the CT500 will feel comfortable closing doors weighing from 40 to 60 Kg. and up to 95 cm. door width.

This capability is achieved in a single model thanks to the variable position installation system.

- » Rack and pinion mechanism for smooth and reliable operation.
- » Two valves to adjust both sweep and latch speeds separately.
- » Two sizes (EN2&EN3) in a single model.
- » Reversible.
- » CT501 model permits to hold the door open at any position between 0° and 180°.
- » Suitable for doors opening inwards or outwards.:
 - Standard mounting: Door opens INWARDS, mounting on the pull side.
 - Transom mounting: Door opens OUTWARDS, mounting on the push side.
- » Four finishes: BL: White, NE: Black, PL: Silver, OR: Gold

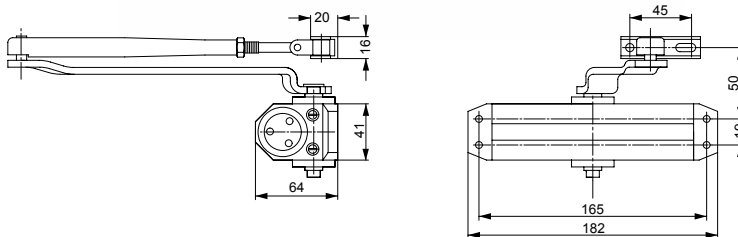

Mounting on pull side

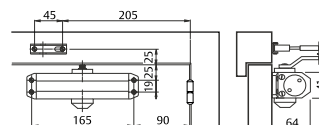

Mounting on push side

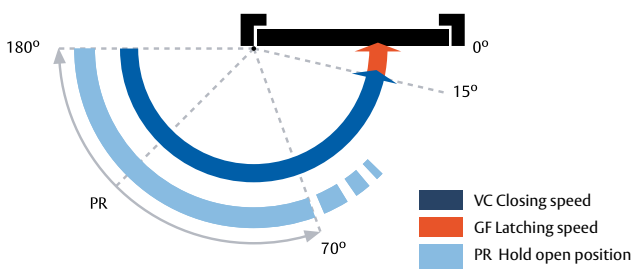
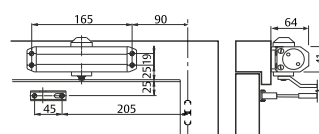

Standard arm			
Size	Code	Finish	
2 - 3	CT50023BL	White	
2 - 3	CT50023NE	Black	
2 - 3	CT50023OR	Gold	
2 - 3	CT50023PL	Silver	
Hold open arm			
Size	Code	Finish	
2 - 3	CT50123BL	White	
2 - 3	CT50123NE	Black	
2 - 3	CT50123OR	Gold	
2 - 3	CT50123PL	Silver	

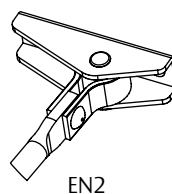

EN2

Size

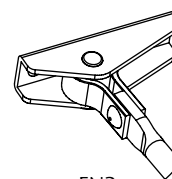

EN3