



FIRE-RATED DOOR  
**DELTA MODEL**  
**El<sub>2</sub> 60**

GENERAL FEATURES

Delta fire rated model is a steel, swing door. It has been tested according to EN 1634-1 standards in accredited laboratories, achieving EI2 60 fire resistance classification according to **EN 13501-1**. It also has a C5 self-closing durability classification.

The Delta door is CE marked according to **EN 16034-1** and **EN 14351-1**, standards for fire doors and external pedestrian doors respectively.



NOMENCLATURE

Nominal door dimensions expressed in mm.

FRAME	NOMINAL DIMENSIONS
CS5	Internal Frame Width Dimensions +20 mm x Internal Frame Height Dimensions +10 mm. <i>Exemple: 900x2050 CS5.</i>

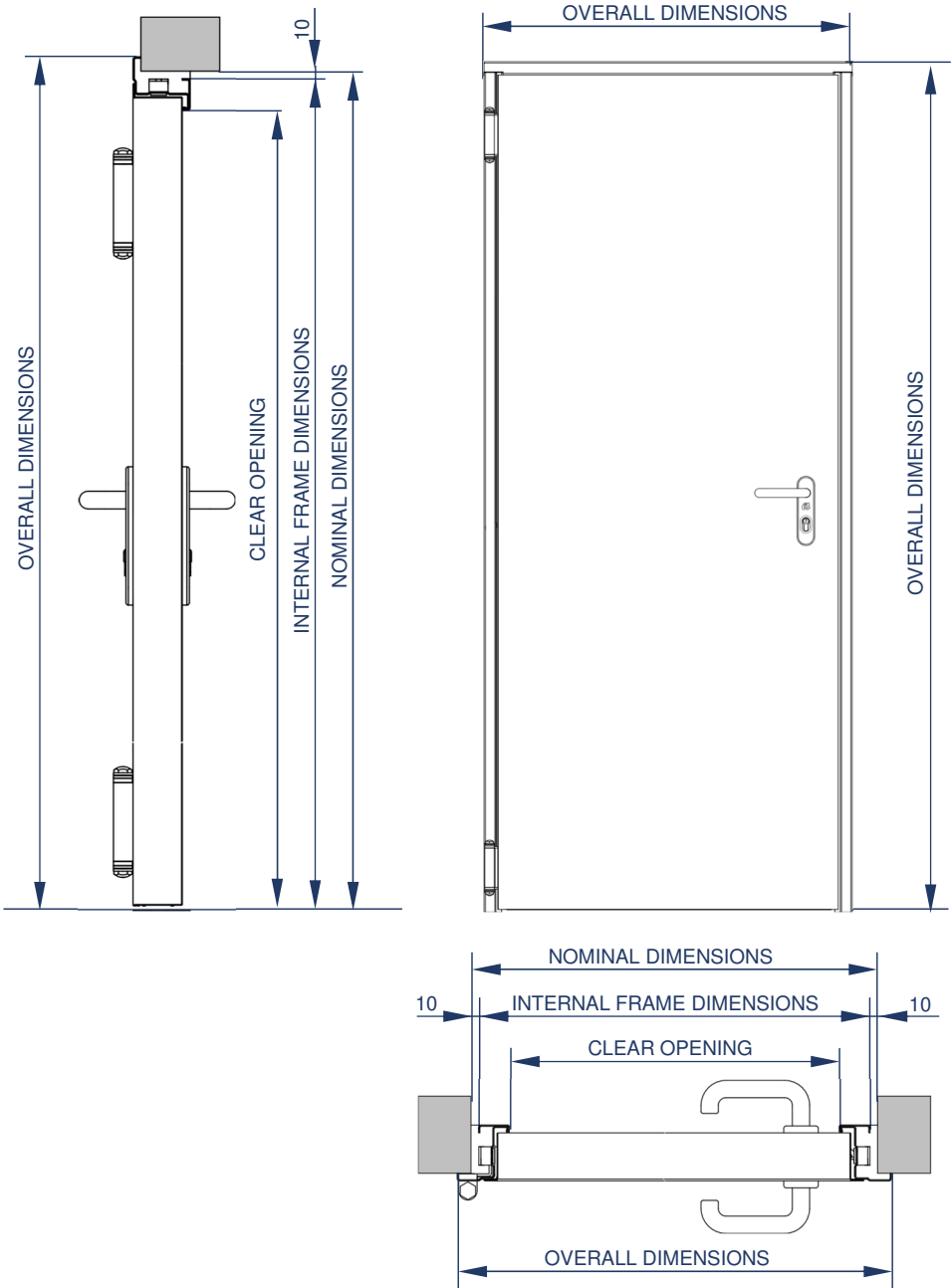

OPENING SENSE

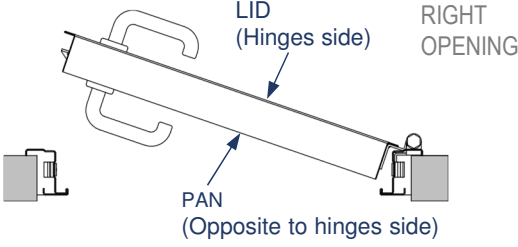
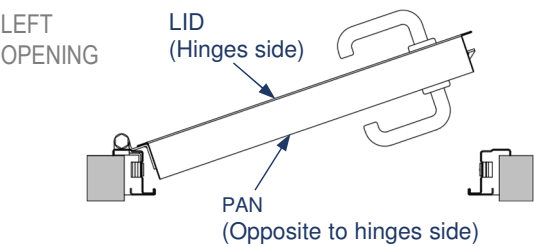

STANDARD DIMENSIONS

NOMINAL DIMENSIONS	CLEAR OPENING	INTERNAL FRAME DIMENSIONS	OVERALL DIMENSIONS
800 x 2050	700 x 2000	780 x 2040	836 x 2068
800 x 2100	700 x 2050	780 x 2090	836 x 2118
800 x 2150	700 x 2100	780 x 2140	836 x 2168
900 x 2050	800 x 2000	880 x 2040	936 x 2068
900 x 2100	800 x 2050	880 x 2090	936 x 2118
900 x 2150	800 x 2100	980 x 2140	936 x 2168
1000 x 2050	900 x 2000	980 x 2040	1036 x 2068
1000 x 2100	900 x 2050	980 x 2090	1036 x 2118
1000 x 2150	900 x 2100	980 x 2140	1036 x 2168

Available dimensions.

FINISHES



PRE-LACQUERED  
ANDREU WHITE



GALVANISED

DOORLEAF

HINGES

Hinges screwed to the leaf and riveted to the frame.



GAS OUTLET HOLES

They prevent gas accumulation in case of fire.

ESCUTCHEON WITH HANDLE

Ø 20 mm handle, 9 mm spindle and black nylon plate.



LOCK

Steel reversible 1 point closing lock with CE with 72mm keyhole.

CYLINDER

Dimensions 35x35 mm with 3 keys. Nickel finish.



IDENTITY PLATE

Reflects the most significant features of the door.



ANTI-CROW BAR BOLT

Placed on the edge of the leaf, between hinges.

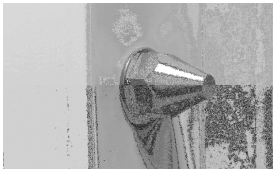

LID  
(Hinges side)

DOORLEAF FEATURES

Door leaf thickness	62,6 ± 2 mm.
Edge Type	17± 2 mm width and 2 mm thick edge.
Hinges	2 Galvanised steel hinges, 3mm thick with CE marking.
Material Type / Thickness	Galvanized Steel / Thickness 0,6 mm.
Available Finishes	Pre-lacquered Andreu White. Galvanised Steel.
Internal Filling	Combination of fire-retardant and fire-resistant materials: rock wool and plasterboard plates.
Anti-crow bar bolt	1 Anti-crow bar bolt nickel made placed between hinges.
Locking System	1 point lock.
Identity Plate	Contains information such as: manufacturing number, fire classification, traceability and test report number.

## FRAME

### FRAME UNION

Screwed height and width connection system.



### ANTI-CROW BAR PROTECTOR

Embedded inside the frame.



### INSTALLATION SYSTEM TO THE WALL

Available with anchors and screwing system for installation.



### INTUMESCENT JOINT

20x2mm perimetral joint glued on the internal part of the frame

### CARTER LATCH PROTECTOR

Made of stainless Steel for White finish doors and of Galvanised steel for galvanised doors.



### LOWER BAR

It helps to define floor level, ensures door stability and keeps clearance during installation.



## FRAME FEATURES

Standard Frame	CS5 Frame.
Material Type / Thickness	Galvanised steel / 1,5 mm thickness.
Available Finishes	Pre-lacquered Andreu White. Galvanised Steel.
Fixation system to the wall	Anchors / Screwing system.
Lock position	Stainless Steel or galvanised carter latch protector.
Anti-crow bar bolt protector	Anti-crow bar bolt protector
Inside Box	Yes
Opcional Frames	Under request.
Joints and Seals	Perimeter intumescent seal.
Assembly System / Frame junction between height and width	Screwed / Straight junction.

## STANDAR FRAME

### ■ CS5 Corner Frame.

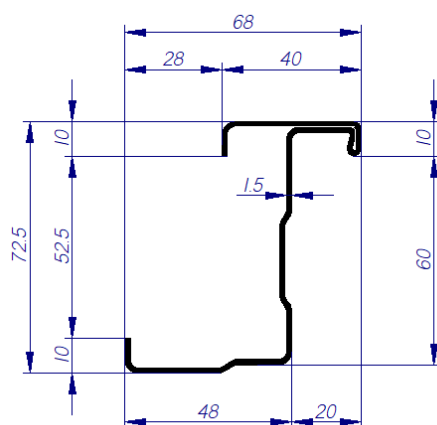

CS5 Frame Section

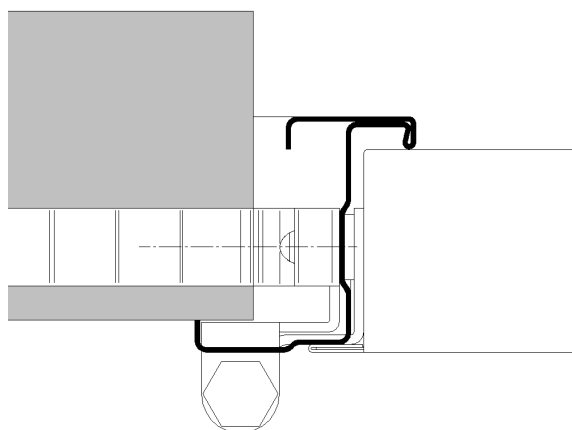

Installation with anchors to the wall

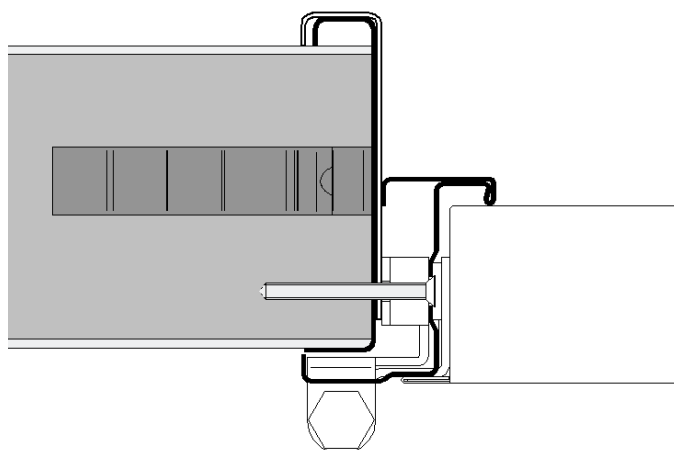

Installation with screws to the wall

Set of CS5 Frame + Counterframe with Sub frame

## STANDARD HARDWARE

■ **HANDLE WITH PLATE.** In-house manufacturing, composed of steel cover supports with black nylon plates and handles. 9 mm spindle with 72 mm keyhole.

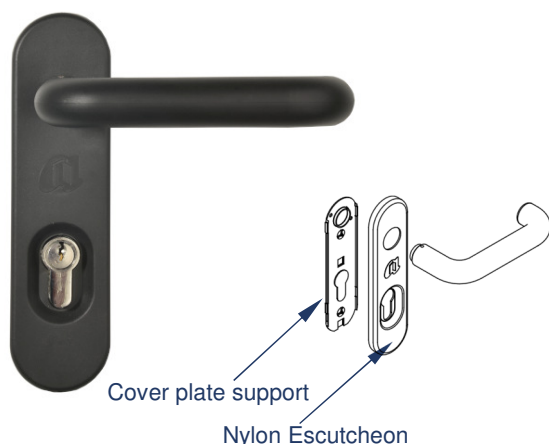

**OPTIONAL:** Other combinations allowed:

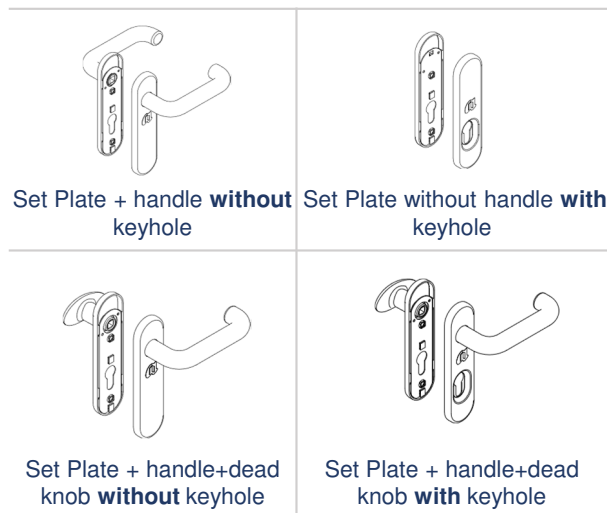

■ **LOCK.** Steel made reversible lock with zinc forehead. Embedded in the door leaf edge. 72mm keyhole, 9mm follower and 65 mm backset. It has CE marking in accordance with the UNE-EN 12209 standard.

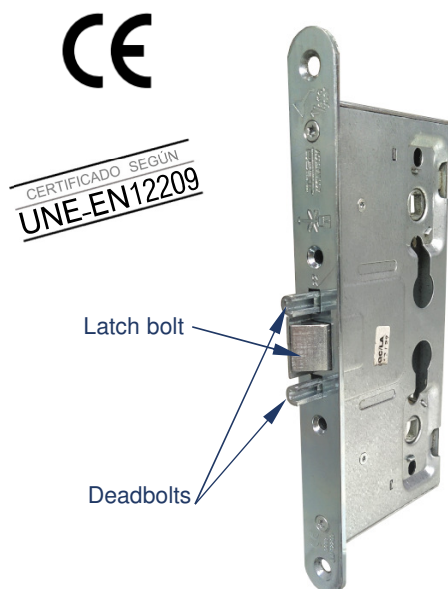

■ **HINGES.** In-house design and manufacturing according to UNE-EN 1935 standards with CE marking. Made of 3mm thick galvanised steel, screwed to the leaf and clinched to the frame.

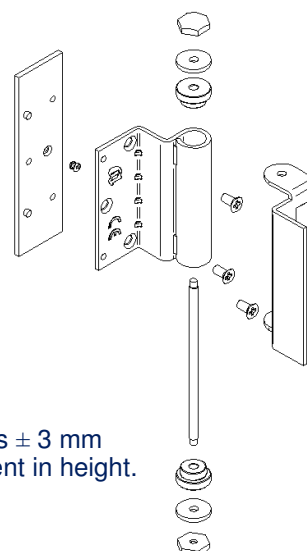

Allows  $\pm 3$  mm adjustment in height.

■ **ANTI-CROW BAR BOLT.** Steel galvanised bolt installed between hinges.



■ **CYLINDER.** 35x35 mm with nickel finish.



## ALLOWED ACCESSORIES

- **STAINLESS STEEL AISI 316 PLATE WITH HANDLE.** 72 mm keyhole.



Other combinations:

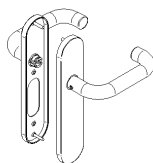

Set Plate + handle **without** keyhole

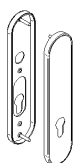

Set Plate **without** handle with keyhole

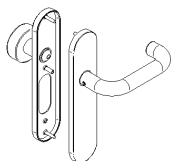

Set Plate + handle + dead knob **without** keyhole

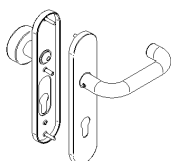

Set Plate + handle + dead knob **with** keyhole

- **PANIC FUNCTION LOCK.** Steel made reversible lock with zinc forehead. Embedded in the door leaf edge. 72mm keyhole, 9mm follower and 65 mm backset. It has CE marking in accordance with the UNE-EN 12209 standard.

CE

CERTIFICADO SEGÚN  
UNE-EN12209



- **HINGES WITH SPRINGS.** In-house design and manufacturing, made of 3mm thick galvanised steel, screwed to the leaf and clinched to the frame.

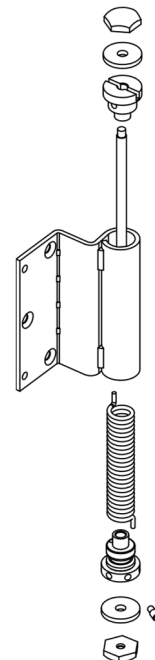

- **DOOR CLOSERS.** Normal preinstallation (hinges side) with inside opening, installed on the frame and door leaf. Available with preinstallation and pack (preinstallation with accessory). The door closer preinstallation will depend on the door leaf width dimensions and on its weight.

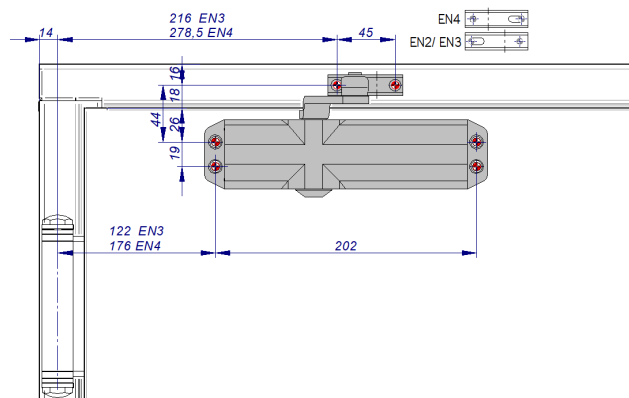

4º digit

	Talleres de Escorial, S.A.U. Barrio de Ventas, 30 E-20105 IRUN SPAIN					06		
	1121-CPD-AD0131	EN1154:1996+A1:2002	3	8	4 2	1	4	



ALLOWED ACCESSORIES

■ **EI<sub>2</sub> 60 VISION PANEL.** Stainless steel AISI 430 porthole frames with glossy finish and 25mm thick Pyrobel glass.

- **Rectangular vision panel dimensions:** 200 x 200 mm.
- **Round vision panel dimensions:** Ø 200 mm.



Rectangular porthole



Round porthole

- **Screwing system:** Porthole frames can be fixed with visible or concealed screws.

Visible fitting screw

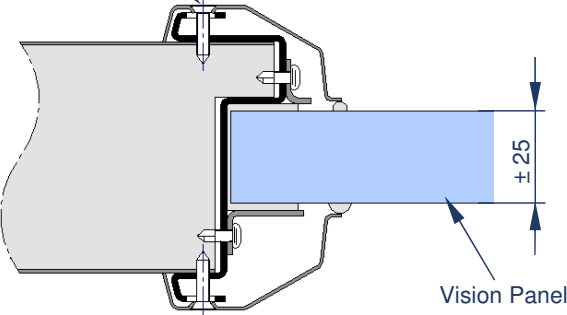

Concealed fitting screw

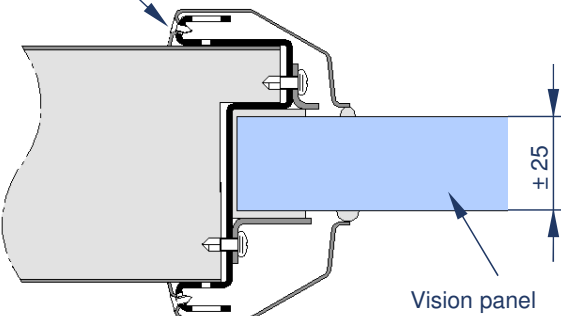

- **PANIC devices.** To be installed on pushing side (Opposite to hinges side).



2000N Panic Devis



Stainless Steel 2000N  
Panic Device

PANIC DEVICE  
2000N

- With **embedded lock**
- Black nylon supports and grey bar
- With **embedded lock**
- Satin steel supports with stainless steel bar



Panic Device Quick  
1 Point



Superimposed Panic  
Device Quick 1 Point



Superimposed Panic  
Device Quick 3 Points

PANIC DECIVE  
QUICK 1 Point  
without keyhole

- With embedded lock
- Black supports with black or red bar

PANIC DECIVE  
QUICK 1 Point  
without keyhole

- Superimposed panic device without lock
- Black supports with black or red bar

PANIC DECIVE  
QUICK 2/3 Pts  
without keyhole

- Superimposed panic device without lock
- Black supports with black or red bar

## ALLOWED ACCESSORIES

■ **INTUMESCENT LOUVRERS.** An important element on fire rated doors. When the louver receives heat from the fire, it expands, which prevents smoke and flames spread.

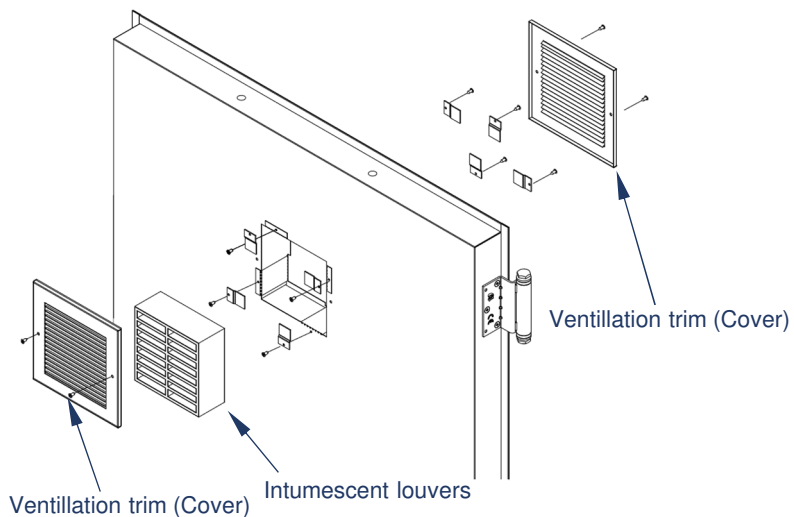

### • Intumescent louver dimensions:

- 150 x 150 mm.
- 300 x 150 mm.
- 400 x 300 mm.

### • Ventilation trim (Cover) for intumescent louvers:

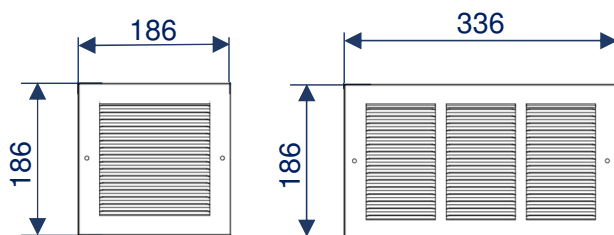

Cover for 150x150 Louver

Cover for 300x150 Louver

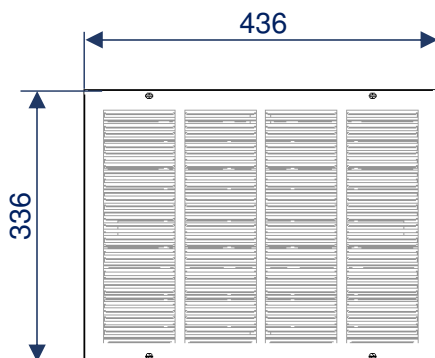

Cover for 400x300 Louver

### • Ventilation position on the door leaf:

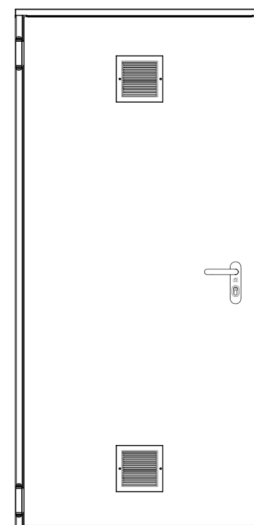

INTUMESCENT LOUVER UPPER AND BOTTOM

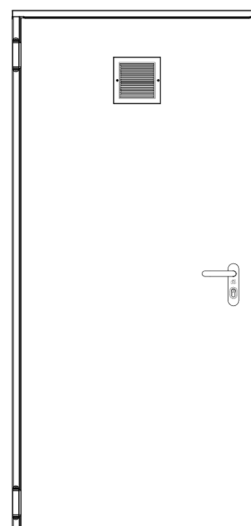

INTUMESCENT LOUVER UPPER

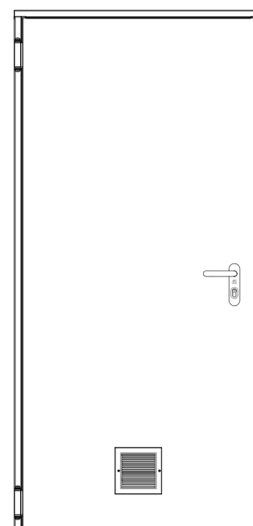

INTUMESCENT LOUVER BOTTOM



## SUBFRAMES

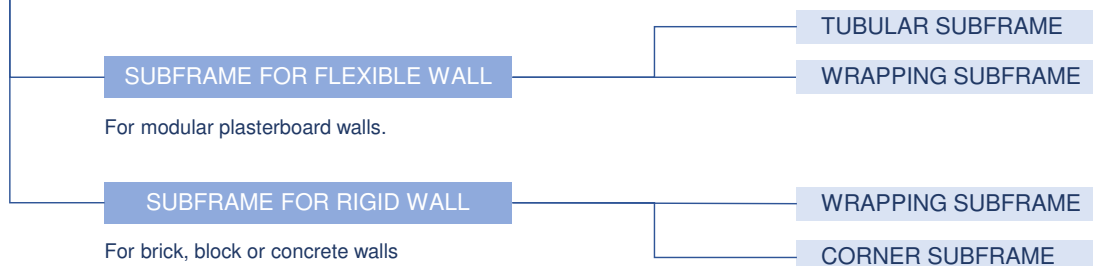

## ■ TUBULAR SUBFRAME FOR FLEXIBLE WALL

Subframe for **CS5** Frame.

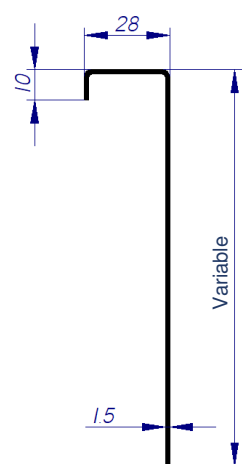

Section for TUBULAR Subframe

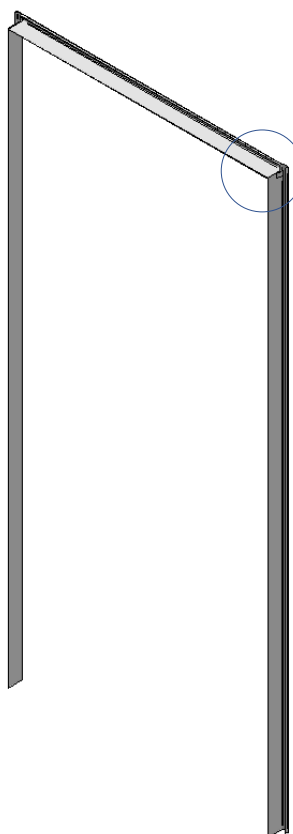
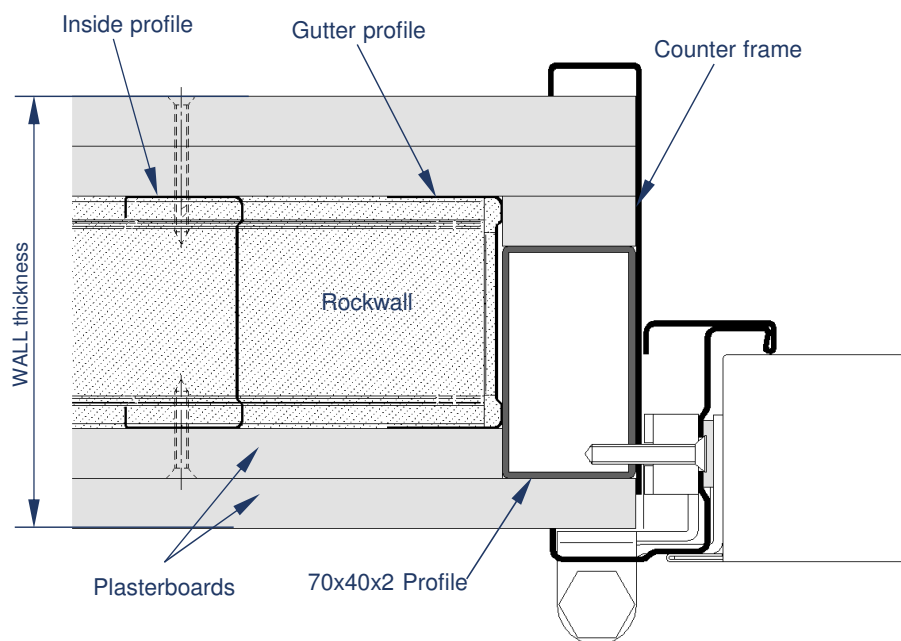

## ASSEMBLING

The counter frame is assembled with the help of flaps

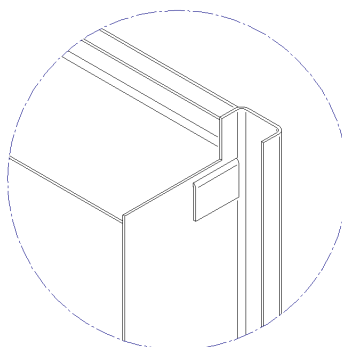

## ■ WRAPPING SUB-FRAME FOR FLEXIBLE WALL

Sub-frame for **CS5** Frame.

**Steel type:** 1,5 mm thick galvanised steel

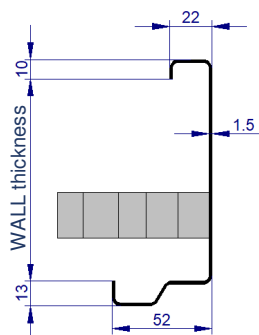

Wrapping Sub-frame with moulding Section

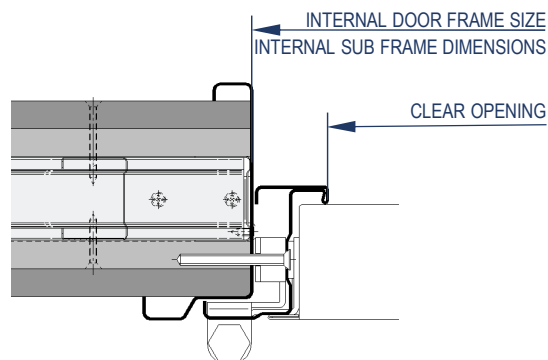

CS5 Frame + Wrapping Sub-frame

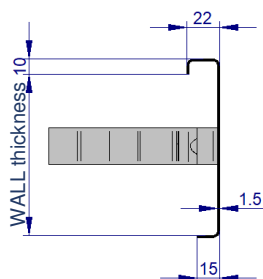

Wrapping Sub-frame without moulding Section

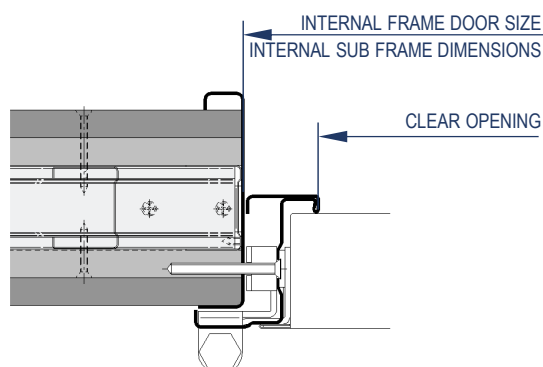

CS5 Frame + Wrapping Sub-frame without moulding

### EXTENSIONS

These extensions have a maximum length of 2500 mm for anchoring the subframe to the ceiling

### FLOOR ANCHORING

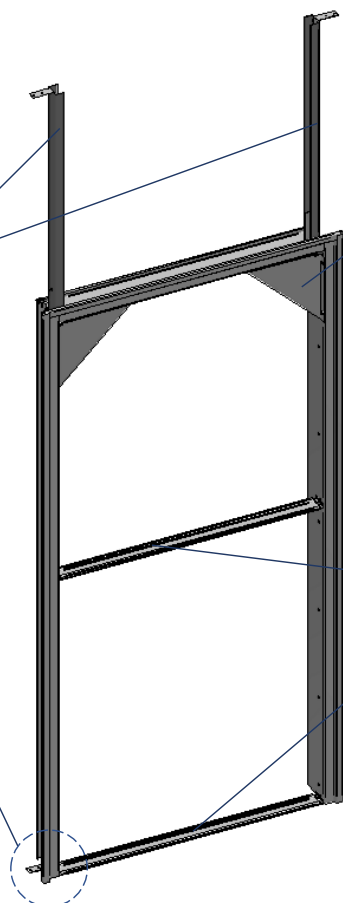
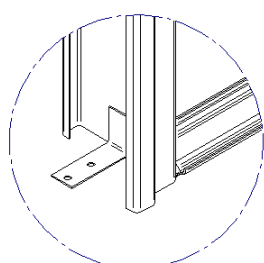

### BRACKETS



### LOWER BAR

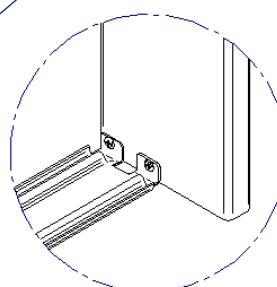

## WRAPPING SUB FRAME FOR RIGID WALL

Sub-frame for **CS5** Frame.

**Steel type:** 1,5 mm thick galvanised steel

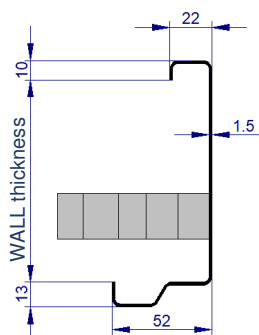

Wrapping Sub-frame with moulding Section

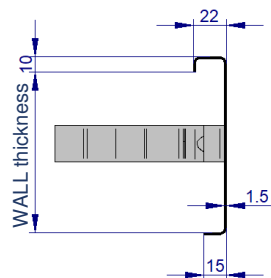

Wrapping Sub-frame without moulding Section

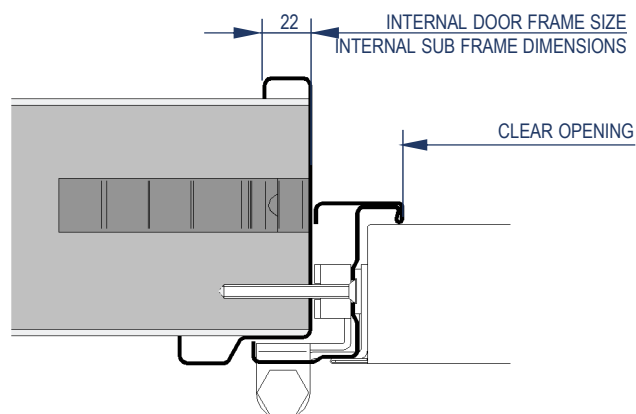

CS5 Frame + Wrapping Sub-frame

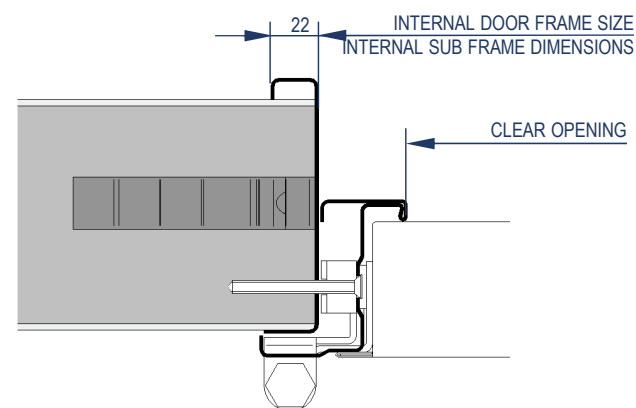

CS5 Frame + Wrapping Sub-frame without moulding

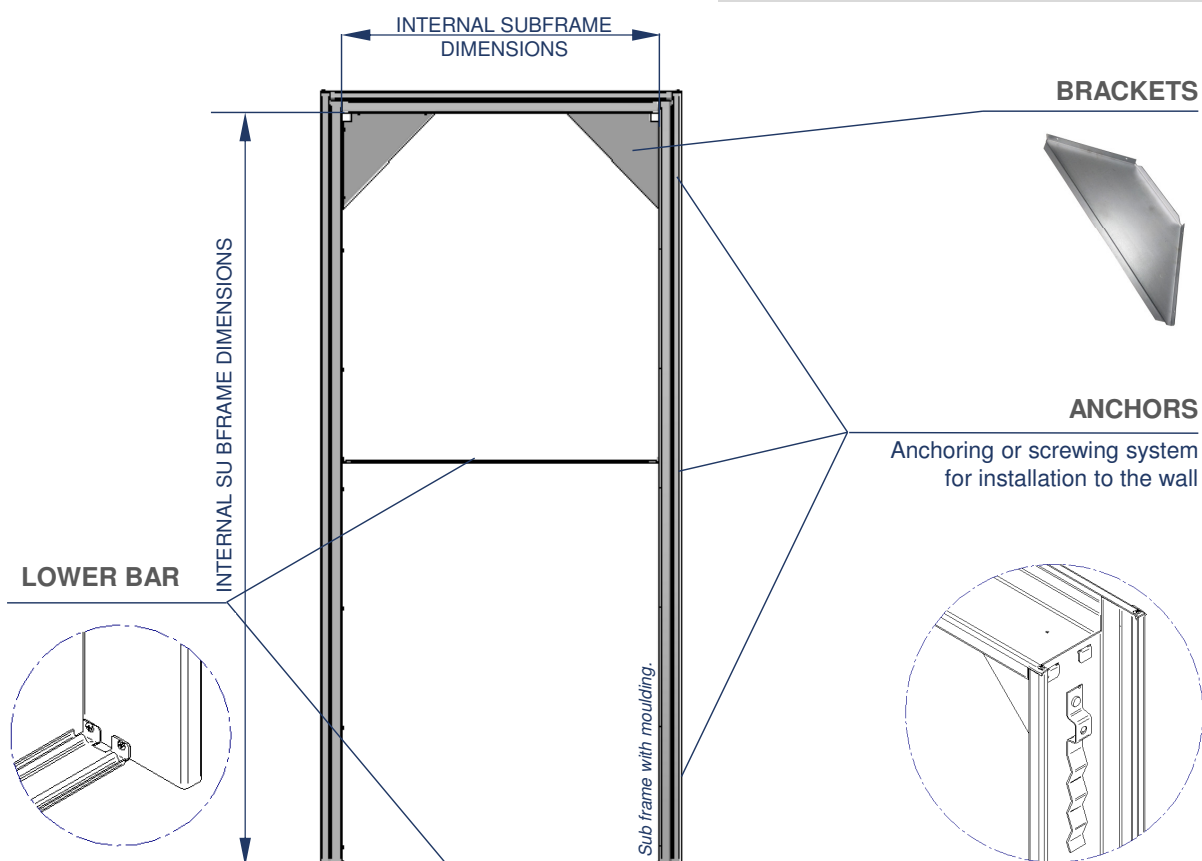

## CORNER SUB FRAME FOR RIGID WALL

Sub-frame for **CS5** Frame.

**Steel type:** 1,5 mm thick galvanised steel

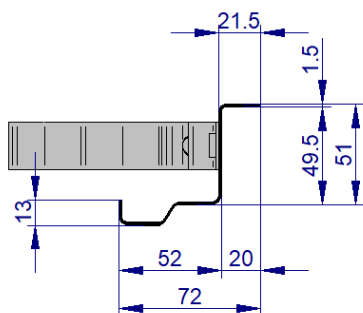

Corner Sub-frame with  
moulding Section

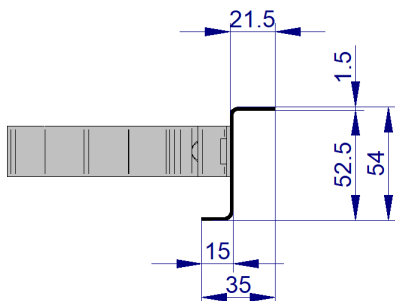

Corner Sub-frame without  
moulding Section

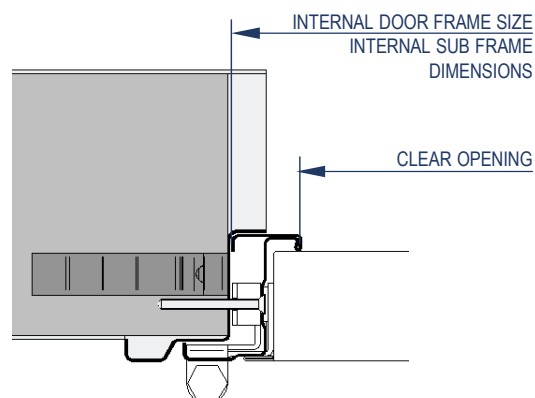

CS5 Frame + Corner Sub-frame

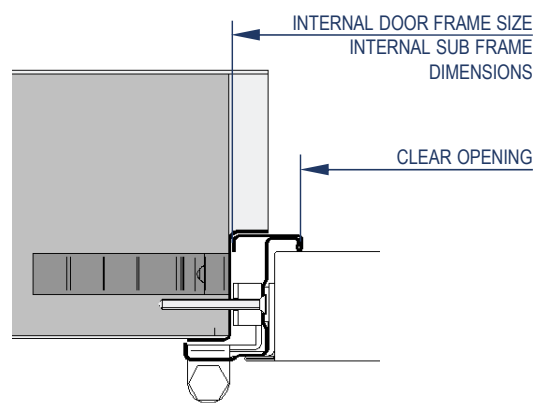

CS5 Frame + Corner Sub-frame without moulding

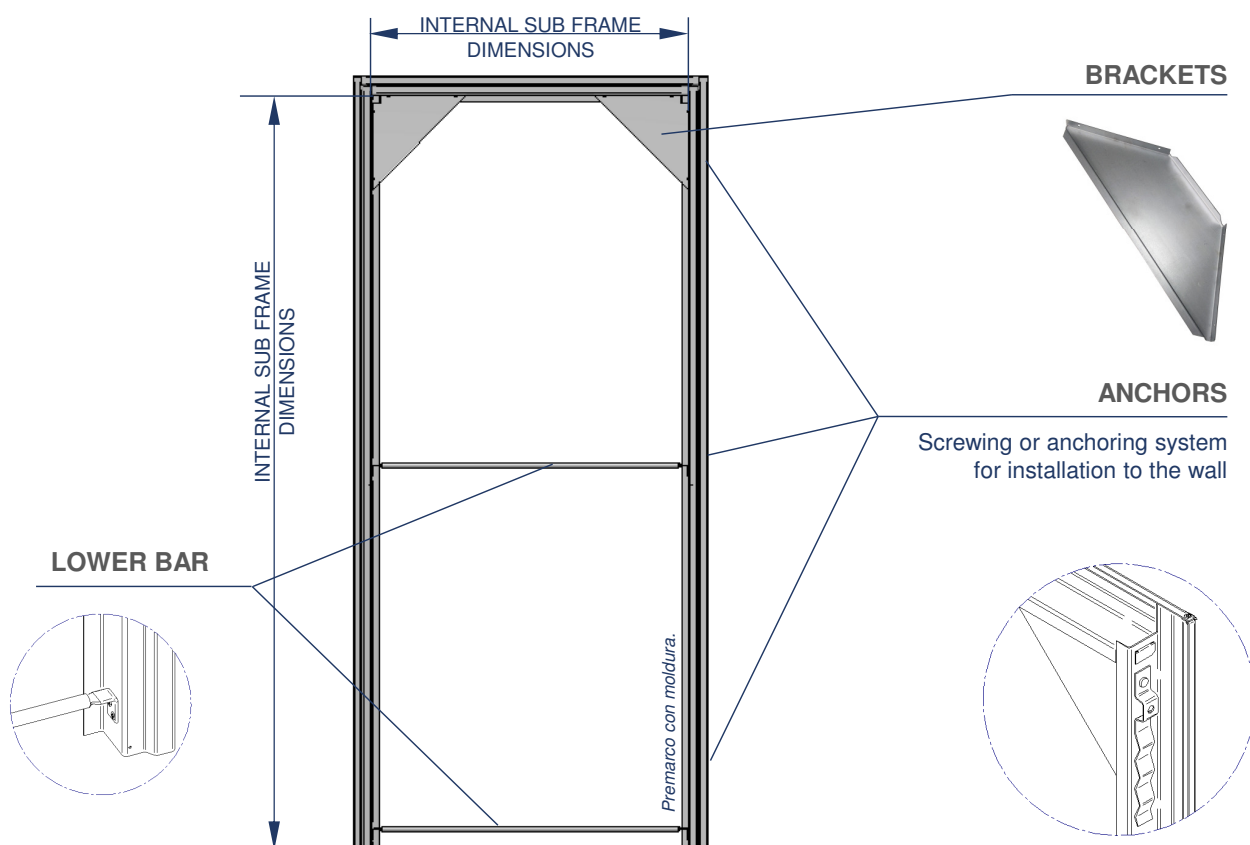

## WIDE FRAME SUPPLEMENT

- **Wide frame supplement for CS5 Frame.** Allows to adapt the CS5 frame to the wall thickness. Prepared to be installed on site with mortar.

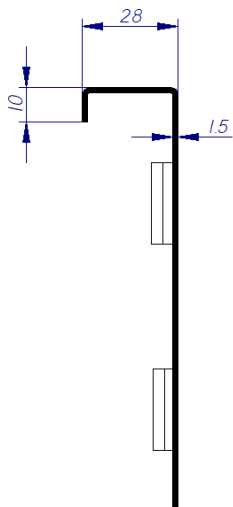

Wide frame Section

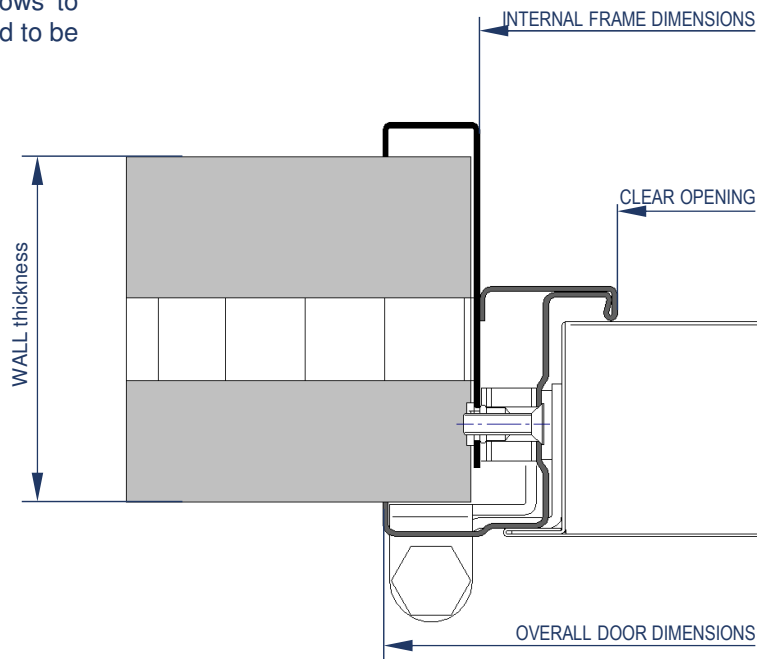

CS5 Frame + Wide frame supplement

- **Wide frame supplement installation.** The wide frame is assembled together with the door before installation. Then the wall is raised with the door assembled to the wide frame.

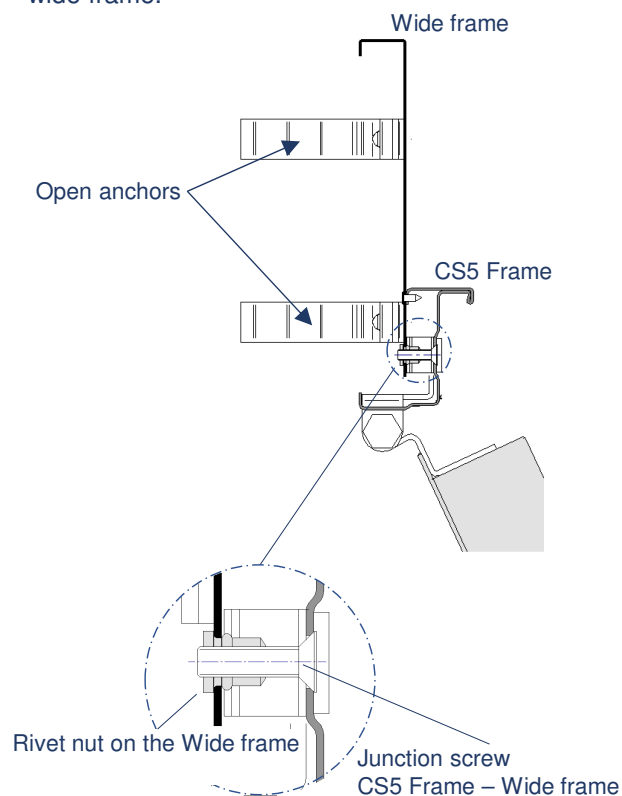

Connection between Wide Frame and CS5 Frame

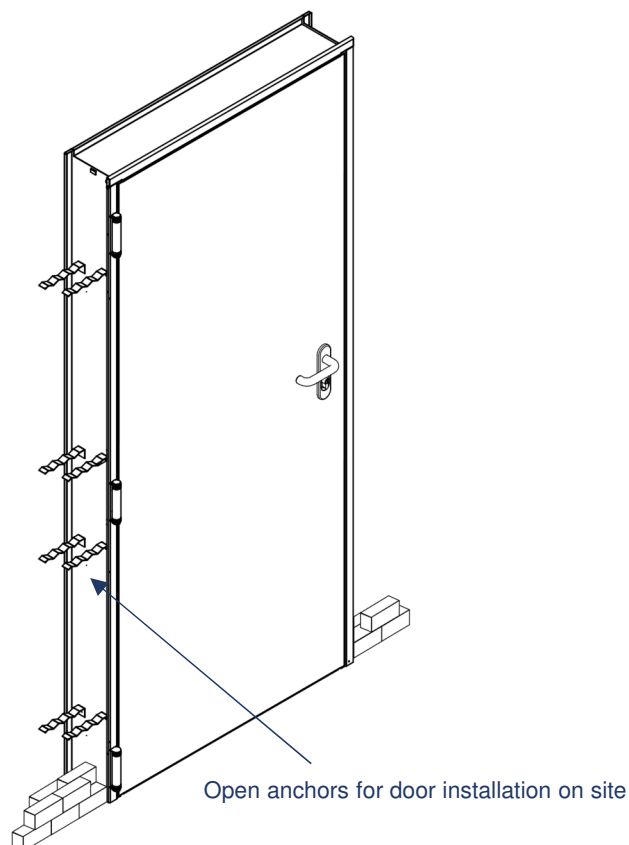

## VERTICAL PALLETISATION

- Vertical pallet, One By One system.



	Vertical Pallet
Nº of doors	15 pcs
Pallet Width	1,18 m
Pallet Length	0,95 m
Pallet Height	2,27 m
Approximate weight	781 Kg*

\* Dimensions issued for Palet of DELTA model with order size 800 x 2050 CS5.

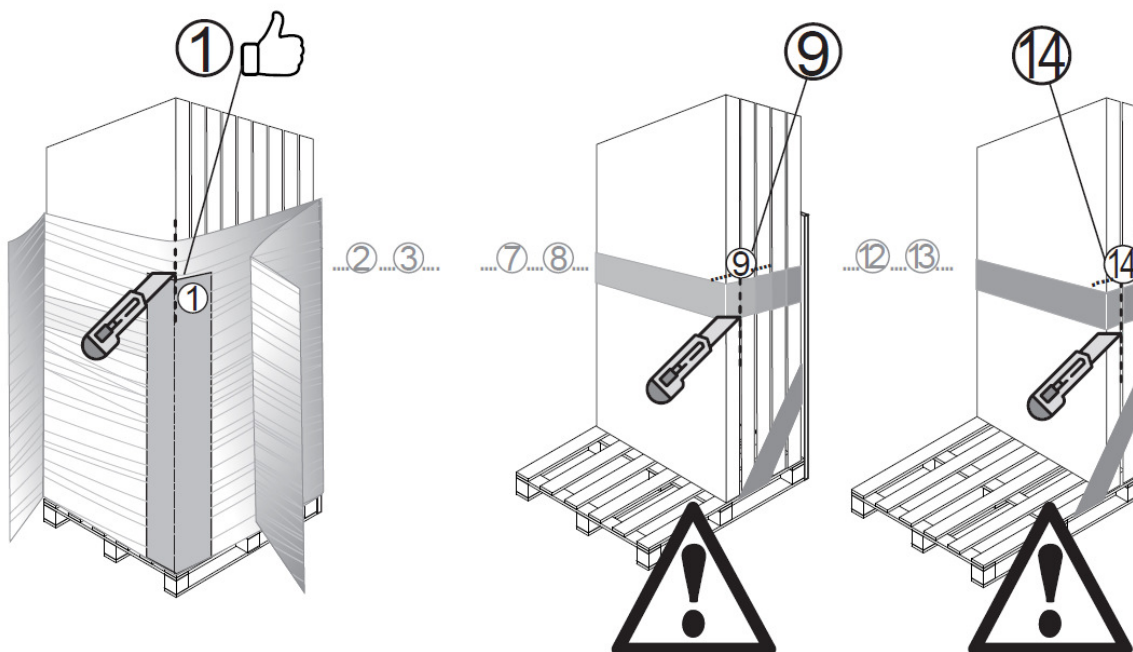

To remove the doors, cut the film strictly following the instructions and the numerical order.

PALLET HANDLING AND OPENING INSTRUCTION "ONE BY ONE" (15 UNITS)



## REGULATION

- Product Range: Fire Rated doors (Delta Fire Rated model door Single leaf)
- This door has been tested according to EN 1634-1, in accredited laboratories, and its results have been classified according to EN 13501-1, reaching EI2 60 fire resistance classification. In addition, this door has been subjected to self-closing durability tests in accredited laboratories, according to EN-1191, reaching the C5 classification. In consequence, this fire door is able to withstand 200,000 cycles of opening and closing.
- The Delta door owns CE trademark, in accordance with **EN 16034-1** "Pedestrian, industrial, commercial, garage doors and casement windows. Product standard, performance characteristics. Fire resistance and/or smoke control characteristics" and EN 14351-1, "Windows and doors. Product standard, performance characteristics. Part 1: Windows and external pedestrian doors", following the system 1 of assessment and verification of constancy of performance.
- The CE marking performance is detailed in the Declaration of Performance. (DoP DELTA 1/6 1H v1).

## Delta EI2 60 C5



## DECLARATION OF PERFORMANCE (DoP)

Essential features	Performance
<b>Resistance to fire</b>	EI2 60
<b>Smoke control</b>	NPD
<b>Self closing</b>	C
<b>Durability of self-closing:</b> Against degradation (Cycle testing) Against ageing (Corrosion)	5 Achieved
<b>Dangerous Substances</b>	NPD
<b>Height</b>	Detailed in the order
<b>Ability to release</b>	Released
<b>Durability of ability to release</b>	Sustained release
<b>Ability to release (locked doors on escape routes only)</b>	It opens (*)

### NPD: Undeclared Performance.

(\*) This performance will be conditioned by the fact if the door is equipped with emergency exit devices, hinges and panic devices according to standards EN-179, EN-1935, EN-1154 and EN-1125.



**andreu**

The Steel Door Company